

**DAD
SERIES**

II 2 GD EEx e/d IIC IP66

APPLICATION

- **Armoured cable**
- Inner and outer seals, armour grounding
- For outdoor with complete protection of cable armour

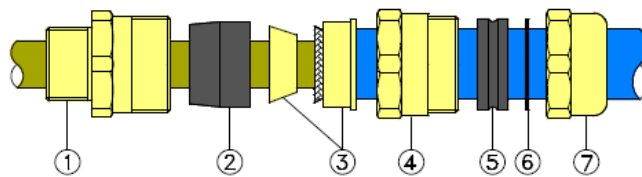

- 1- BODY
- 2- INNER SEAL
- 3- ARMOUR CLAMPING RING
- 4- MIDDLE BODY
- 5- OUTER SEAL
- 6- WASHER
- 7- GLAND NUT

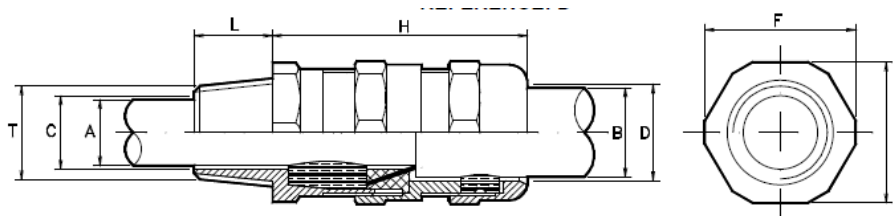

Designation example : **DAD1.1015 M20x1.5**

Size	THREAD T	REF.	CABLE DIMENSIONS (mm)				GLAND DIMENSIONS (mm)				
			A		B		C	D	H	E	F
			MIN	MAX	MIN	MAX					
0	3/8"NPT-M16x1.5- Pg9/11	DAD0.7	4	7	10	15	11	16	53	24	26
	1/2"NPT-M20x1.5- Pg13.5	DAD0.10	7	10							
1	1/2"NPT-M20x1.5- Pg13.5 3/4"NPT- M25x1.5pg16	DAD1.8*	5.5	8	10	15	11	20	65	32	35
		DAD1.10*	8	10.5	14	19					
		DAD1.13*	10.5	13							
2	3/4"NPT-M25x1.5- Pg16	DAD2.13*	10.5	13	15	20	14	25	65	36	39
		DAD2.15*	13	15.5	19	24					
		DAD2.18*	15.5	18							
3	1"NPT-M32x1.5- Pg21	DAD3.18*	15	18	20	26	25	32	82	45	49
		DAD3.21*	18	21	25	31					
		DAD3.24*	21	24							
4	1"1/4NPT-M40x1.5- Pg29	DAD4.24*	21	24	26	32	31	38	83	50	55
		DAD4.27*	24	27	31	37					
		DAD4.30*	27	30							
5	1"1/2-M50x1.5- Pg36	DAD5.27*	24	27	31	37	37	44	83	57	62
		DAD5.30*	27	30	36	43					
		DAD5.33*	30	33							
		DAD5.36*	33	36							
6	2"NPT-M63x1.5- Pg42	DAD6.39*	36	39	42	48	47	54	83	67	73
		DAD6.42*	39	42	47	53					
		DAD6.45*	42	45							
7	2"1/2NPT-M75x1.5- Pg48	DAD7.48*	45	48	52	58	57	65	83	80	88
		DAD7.51*	48	51	58	64					
		DAD7.54*	51	54							

ATEX
CABLE GLANDS

