

LINEAR X

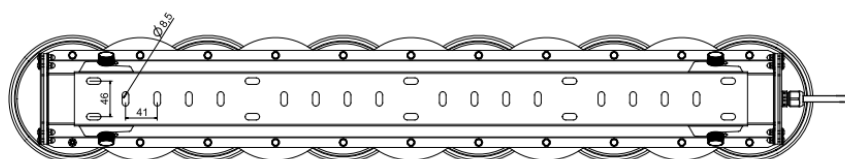

ESPECIFICACIONES TÉCNICAS

Certificado:	BK120ATEX0003X
Marcado:	II 2G Ex eb mb IIC T6 Gb II 2D Ex tb IIIC T85°C Db
Temperatura:	-20°C ≤ T _a ≤ +50°C
Tensión:	220-240 V AC
Material:	Aluminio, acero galvanizado, policarbonato
Ángulos del haz:	30° / 60° / 90° / 120° / calle
Temperatura color:	4000 K Opcional: 3000 K y 5000 K
Opcional:	DALI, DSI, DIM switch

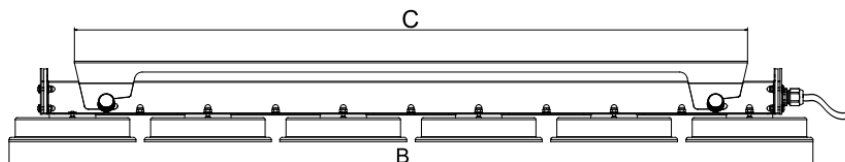
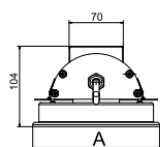

Ref	Descripción	Potencia	LM	Dimensiones (AxBxC mm)	Peso (Kg)
KEXLX3Z1	ExProof Linear X3 Z1	25 W	3450	172x664x470	5,20
KEXLX6Z1	ExProof Linear X6 Z1	50 W	6900	164x1039x870	7,60
KEXLX8Z1	ExProof Linear X8 Z1	65 W	9200	164x1389x1200	10,85
KEXLX3Z21	ExProof Linear X3 Z21	25 W	3450	172x664x470	5,20
KEXLX6Z21	ExProof Linear X6 Z21	50 W	6900	164x1039x870	7,60
KEXLX8Z21	ExProof Linear X8 Z21	65 W	9200	164x1389x1200	10,85